

INNOVATIVE CENTRAL FLOW TECHNOLOGY

Directflo® pumps are inside out pumps, the fluid is pumped through the center of the pump and compressed air acts on the outside face of the diaphragms.

Important innovations were necessary to realize the central flow concept and, while developing Directflo®, further inventions were made that built on the central flow concept. A few highlights are described below.



03
OTHER FLUIDS
PUMPS



BETTER BY DESIGN

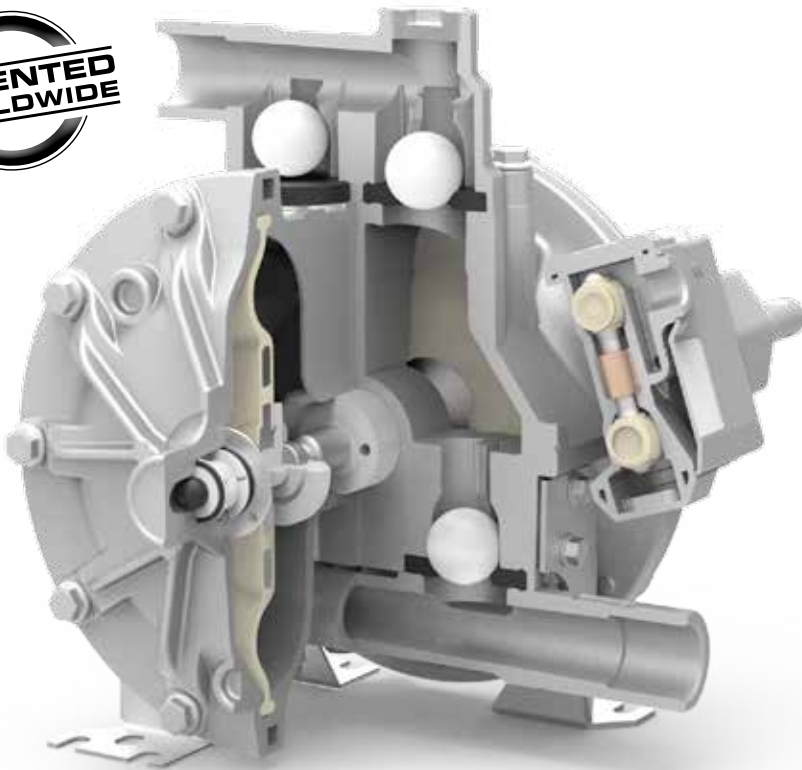

- QUICK AND SIMPLE MAINTENANCE
- REDUCED AIR CONSUMPTION
- COMPACT DESIGN
- SMOOTH RUNNING - LESS PULSATION
- SUPERIOR ALL-ROUND PUMPING PERFORMANCE
- SIMPLE, RELIABLE & DURABLE
- ROBUST

FLUIDS HANDLED

- Oils
- Antifreeze, coolant
- Windshield wash
- Hydraulic fluids
- Brake fluid
- Diesel
- AdBlue®/DEF
- Water
- Waste oil
- Waste antifreeze

Directflo® AND Classicflo® PUMP COMPARATIVE CHART



FLUIDS HANDLED

- Lubricants.
- Antifreeze.
- Windshield wash.
- Diesel.
- AdBlue® / DEF.
- Water.
- Waste fluids.

MARKETS SERVED

- Car and truck dealers.
- Construction, mining.
- Rail and mass transit.
- Lube trucks.
- Fleets.
- In-plant.
- Quick lubes.



POLYPROPYLENE PUMPS

DIRECTFLO® SERIES

	DC20	DF30	DF50	DF100	DP200
PUMP PRESSURE RATIO	1:1	1:1	1:1	1:1	1:1
MAXIMUM FREE DELIVERY⁽¹⁾	5 gal/min (20 l/min)	10 US gal/min (38 l/min)	14 gal/min (50 l/min)	28 gal/min (100 l/min)	53 gal/min (200 l/min)
DELIVERY PER CYCLE APPROX. ⁽¹⁾	0.016 US gal (0,06 liters)	0.04 US gal (0,14 liters)	0.05 US gal (0,2 liters)	0.13 US gal (0,5 liters)	0.26 US gal (1 liter)
AIR PRESSURE OPERATING RANGE	22 to 100 psi (1,5 to 7 bar)	22 to 115 psi (1,5 to 8 bar)	22 to 115 psi (1,5 to 8 bar)	22 to 115 psi (1,5 to 8 bar)	22 to 115 psi (1,5 to 8 bar)
SOLIDS IN SUSPENSION MAXIMUM SIZE	3/32" (2 mm)	1/8" (3 mm)	1/8" (3 mm)	3/16" (4 mm)	1/4" (6 mm)
MAXIMUM DRY SUCTION HEAD⁽¹⁾	6 1/2' (2 m)	13' (4 m)	20' (6 m)	15' (4,5 m)	16' (5 m)
MAXIMUM WET SUCTION HEAD⁽¹⁾	23' (7 m)	26' (8 m)	26' (8 m)	23' (7 m)	26' (8 m)
WEIGHT	2.65 lb (1,2 kg)	4.19 lb (1,9 kg)	4.85 lb (2,2 kg)	11.24 (5,1 kg)	23.15 lb (10,5 kg)
FLUID INLET CONNECTION ⁽²⁾	Int.: 1/4" NPT/BSP (F) Ext.: 3/4" NPT (M)	1/2" NPT (F)	1/2" NPT (F)	1" NPT (F)	1" DIN PN-10 DN25 flange and ANSI B16.5 1" 150 lb flange
FLUID OUTLET CONNECTION ⁽²⁾	Int.: 1/4" NPT/BSP (F) Ext.: 3/4" NPT (M)	1/2" NPT (F)	1/2" NPT (F)	1" NPT (F)	1" DIN PN-10 DN25 flange and ANSI B16.5 1" 150 lb flange
AIR INLET CONNECTION	3/8" NPSM (F)	3/8" NPSM (F)	3/8" NPSM (F)	3/8" NPSM (F)	3/8" NPSM (F)
MANUAL	855 836	855 822	855 822	855 822	855 834

(1) Data measured with water, air inlet pressure 7 bar (100 psi), 20 °C (68 °F).

(2) BSPP thread in models for DEF.

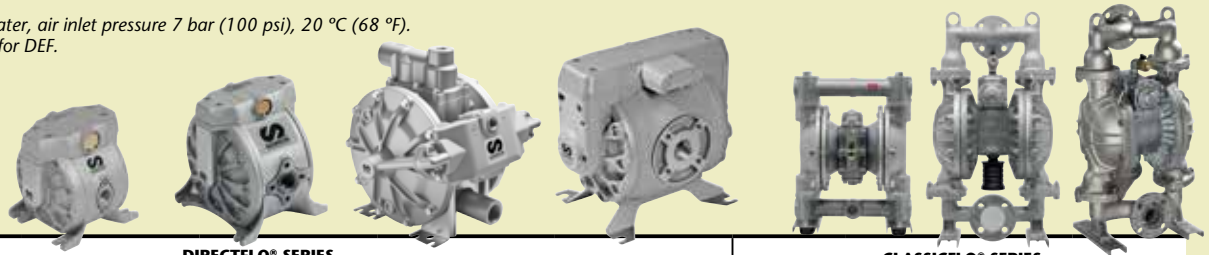

METAL PUMPS

DIRECTFLO® SERIES

CLASSICFLO® SERIES

	DF50	DF100	DP200	DF250	2836	2835	2838	2840
PUMP PRESSURE RATIO	1:1	1:1	1:1	1:1	1:1 UL LISTED	1:1	1:1	1:1
MAXIMUM FREE DELIVERY⁽¹⁾	14 gal/min (50 l/min)	28 gal/min (100 l/min)	53 gal/min (200 l/min)	66 gal/min (250 l/min)	40 gal/min (150 l/min)	46 gal/min (175 l/min)	107 gal/min (400 l/min)	164 gal/min (620 l/min)
DELIVERY PER CYCLE APPROX. ⁽¹⁾	0.05 US gal (0,2 liters)	0.13 US gal (0,5 liters)	0.26 US gal (1 liter)	0.32 US gal (1,2 liters)	0.22 US gal	0.22 US gal	0.73 US gal	1.12 US gal
AIR PRESSURE OPERATING RANGE	22 to 115 psi (1,5 to 8 bar)	22 to 115 psi (1,5 to 8 bar)	22 to 115 psi (1,5 to 8 bar)	22 to 115 psi (1,5 to 8 bar)	21 to 70 psi (1,4 to 5 bar)	21 to 100 psi (1,4 to 7 bar)	22 to 100 psi (1,5 to 7 bar)	23 to 100 psi (1,6 to 7 bar)
SOLIDS IN SUSPENSION MAXIMUM SIZE	1/8" (3 mm)	3/16" (4 mm)	1/4" (6 mm)	1/4" (6 mm)	3/16" (4 mm)	3/16" (4 mm)	9/32" (7,15 mm)	5/15" (8,5 mm)
MAXIMUM DRY SUCTION HEAD⁽¹⁾	20' (6 m)	15' (4,5 m)	16' (5 m)	16.4' (5 m)	N.A.	N.A.	N.A.	N.A.
MAXIMUM WET SUCTION HEAD⁽¹⁾	26' (8 m)	23' (7 m)	26' (8 m)	26' (8 m)	N.A.	18'	18'	19'
WEIGHT	7.72 lb (3,5 kg)	16 lb (7,2 kg)	25.35 lb (11,5 kg)	45 lb (20 kg)	20 lb	27 lb	65 lb	88 lb
FLUID INLET CONNECTION	1/2" NPSM (F)	1" NPT/BSP (F)	1" NPT/BSP (F)	1 1/2" NPT (F) and ANSI 1" B16.5 150 lb flange or 1 1/2" BSP (F) and DIN PN-10 DN40 flange	1" NPTF	1" NPTF	1 1/2" NPTF	Ansi flange and 2" NPTF
FLUID OUTLET CONNECTION	1/2" NPSM (F)	1" NPT/BSP (F)	1" NPT/BSP (F)	1 1/2" NPT (F) and ANSI 1" B16.5 150 lb flange or 1 1/2" BSP (F) and DIN PN-10 DN40 flange	1" NPTF	1" NPTF	1 1/2" NPTF	Ansi flange and 2" NPTF
AIR INLET CONNECTION	3/8" NPSM (F)	3/8" NPSM (F)	3/8" NPSM (F)	1/2" NPSM (F)	3/8" NPTF	3/8" NPTF	1/2" NPTF	1" NPTF
MANUAL	855 822	855 822	855 834	855 829	M002836	M00191	M00192	M00193

(1) Data measured with water, air inlet pressure 7 bar (100 psi), 20 °C (68 °F).

Product specifications are subject to change without prior notice

556 115

DC20 POLYPROPYLENE DIAPHRAGM PUMP. 5 GAL/MIN

Very compact and reliable polypropylene diaphragm pump for small volume transfer (5 gal/min max.), dosing and spraying a variety of fluids. Polypropylene body and air motor, and PTFE diaphragms and check valve balls for wider chemical compatibility.

03
OTHER FLUIDS
PUMPS



FLUIDS HANDLED

- Antifreeze and antifreeze solutions
- Windshield wash solutions
- Detergents
- AdBlue®/DEF

MARKETS SERVED

- Service shops
- Car dealers
- In plant
- Agriculture

MODELS						
PART No.	PUMP BODY	DIAPHRAGMS	BALLS	SEATS	OTHER WETTED MATERIAL	APPLICATIONS
556 115	Polypropylene	PTFE	PTFE	Polypropylene	Viton®	Antifreeze and Windshield wash solutions, detergents, AdBlue®/DEF

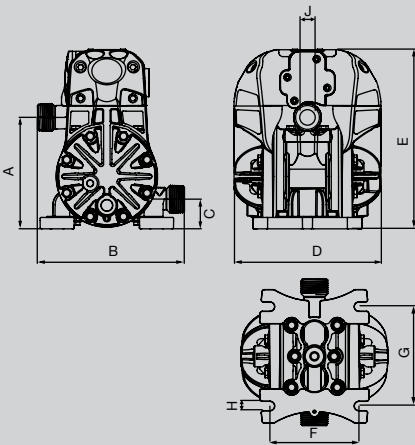

DIMENSIONS Inches

A	B	C	D	E
4 1/4	5 19/32	1 9/64	5 19/32	6 13/16
F	G	H	J	
3 25/64	3 25/32	23/64	1/4 - 3/4 (F)	

Tested at room temperature, with water and flooded pump with 31.5" (800 mm) height of water above the pump inlet.

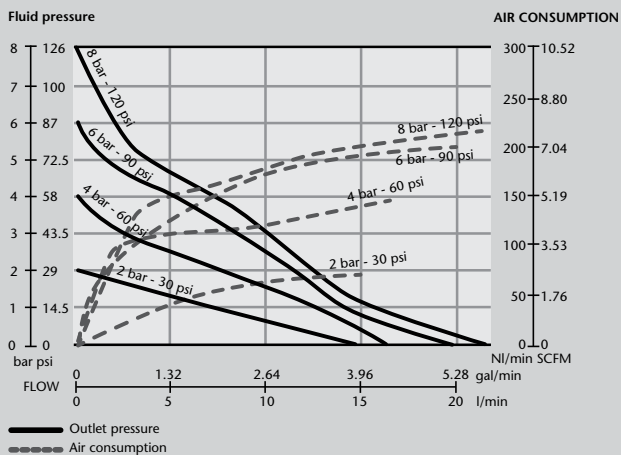

Very compact and reliable polypropylene diaphragm pumps for medium to small volume transfer (10 gal/min), dosing, spraying and dispensing a variety of fluids.

Typical applications are transferring and dispensing Windshield wash and antifreeze solutions, pure Windshield wash and AdBlue®/DEF.

They can be used as stand-alone pumps for transfer applications or as system pumps in small distribution systems that include hose reels.



03
OTHER FLUIDS
PUMPS

FLUIDS HANDLED

- Antifreeze and antifreeze solutions
- Windshield wash solutions
- Detergents
- AdBlue®/DEF

MARKETS SERVED

- Service shops
- Car and truck dealers
- In plant
- Agriculture

MODELS						
PART No.	PUMP BODY	DIAPHRAGMS	BALLS	SEATS	OTHER WETTED MATERIAL	APPLICATIONS
553 164	Polypropylene	Hytrel®	Hytrel®	Stainless steel	Viton®	Antifreeze and Windshield wash solutions
553 164A	Polypropylene	Hytrel®	PTFE	Stainless steel	Viton®	BSP threads, special model for DEF

553 124 Dual inlet pump

Same as pump 553 164 except with 2 x 3/8" NPT (F) dual inlet for 1:1 ratio mixing of fluids with similar viscosities.

Tested at room temperature, with water and flooded pump with 31.5" (800 mm) height of water above the pump inlet.

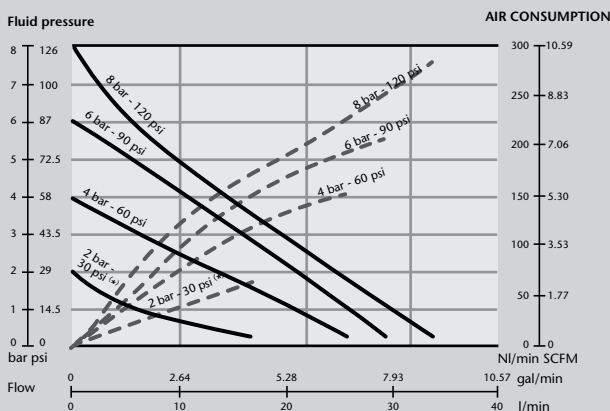

(*) 2 bar test with a PTFE (Teflon®) diaphragm pump.

— Outlet pressure
- - - - - Air consumption

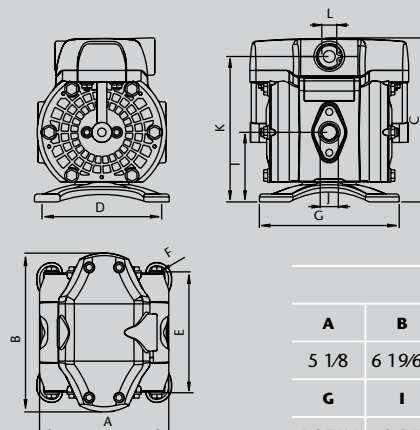

DIMENSIONS Inches					
A	B	C	D	E	F*
5 1/8	6 19/64	6 1/2	4 9/64	4 51/64	5/16
G	I	J	K	L	
5 35/64	2 3/4	1/2 (F)	5 3/4	3/8 (F)	

* Diameter of the holes for fasteners in each of the four pump feet.

DIRECTFLO® SERIES

552 164 / 552 030

DF50 POLYPROPYLENE OR METAL DIAPHRAGM PUMPS. 14 GAL/MIN

03
OTHER FLUIDS
PUMPS



Very compact and reliable diaphragm pumps for medium volume transfer (14 gal/min max.), dosing, spraying and dispensing a variety of fluids.

Typical applications for **polypropylene pumps** are transferring and dispensing of Windshield wash and antifreeze solutions, pure Windshield wash and AdBlue®/DEF.

Metal pumps have an Aluminum air motor. Typical applications for these pumps are transferring and dispensing of Windshield wash and antifreeze solutions; lubricants and diesel; and waste oil evacuation.

They can be used as stand-alone pumps for transfer applications or as systems pumps in distribution systems that include hose reels.

FLUIDS HANDLED

- Antifreeze and antifreeze solutions
- Windshield wash solutions
- Detergents
- AdBlue®/DEF
- Lubricants
- Waste oil

MARKETS SERVED

- Service shops
- Car and truck dealers
- In plant
- Agriculture
- Lube trucks

MODELS						
PART No.	PUMP BODY	DIAPHRAGMS	BALLS	SEATS	OTHER WETTED MATERIAL	APPLICATIONS
552 164	Polypropylene	Hytrel®	Hytrel®	Stainless steel	Viton®	Anti-freeze and windshield wash solutions
552 164A	Polypropylene	Hytrel®	Hytrel®	Stainless steel	Viton®	BSPP threads, special model for DEF
552 010	Aluminum	Hytrel®	Hytrel®	Stainless steel	Viton®	Antifreeze and Windshield wash solutions
552 030	Aluminum	Buna-N	Buna-N	Stainless steel	Buna-N	Antifreeze solutions, lubricants, waste fluids evacuation and transfer

552 124 Same as 552 164 except with 2 x 3/8" NPT (F) dual inlet for 1:1 ratio mixing of pumps with similar viscosities.

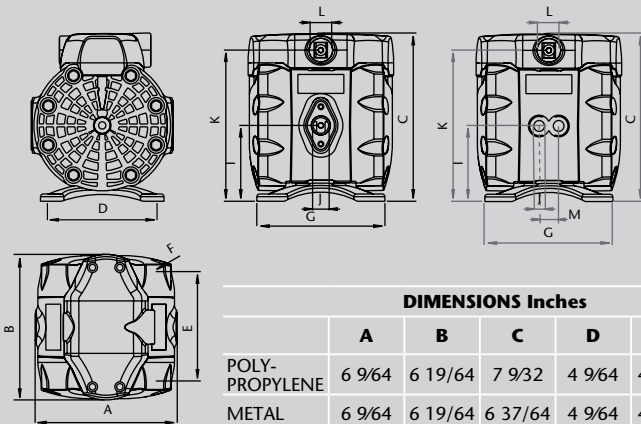

DIMENSIONS Inches						
	A	B	C	D	E	F*
POLY-PROPYLENE	6 9/64	6 19/64	7 9/32	4 9/64	4 51/64	5/16
METAL	6 9/64	6 19/64	6 37/64	4 9/64	4 51/64	5/16
	G	I	J	K	L	
POLY-PROPYLENE	5 35/64	3 17/64	1/2 (F)	6 17/32	3/8 (F)	
METAL	5 3/4	2 3/4	1/2 (F)	5 29/32	3/8 (F)	

Tested at room temperature, with water and flooded pump with 31.5" (800 mm) height of water above the pump inlet.

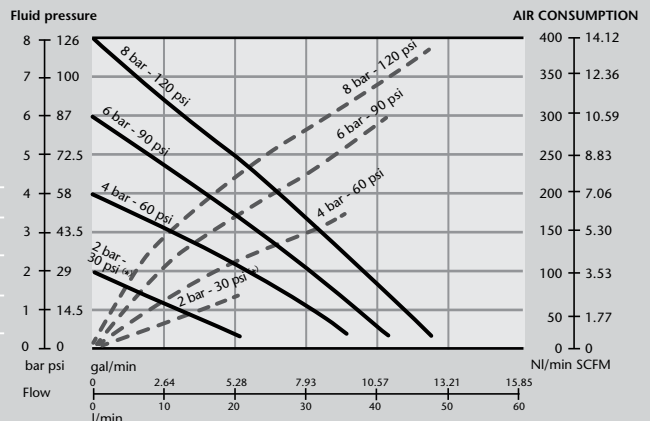

(*) 2 bar test with a pump fitted with PTFE (Teflon®) diaphragms. — Outlet pressure — Air consumption

* Diameter of the holes for fasteners in each of the four pump feet.

DIRECTFLO® SERIES



DF100 POLYPROPYLENE OR METAL DIAPHRAGM PUMPS. 28 GAL/MIN

551 164 / 551 030

Very compact and reliable diaphragm pumps for medium to large volume transfer (28 gal/min max.), dosing, spraying and dispensing a variety of fluids.

Typical applications for **polypropylene pumps** are transferring and dispensing of Windshield wash and antifreeze solutions, pure Windshield wash and AdBlue®/DEF.

Metal pumps have an aluminum air motor. Typical applications for these pumps are transferring and dispensing of Windshield wash and antifreeze solutions; lubricants and diesel; and waste oil evacuation.

They can be used as stand-alone pumps for transfer applications or as systems pumps in distribution systems that include hose reels.



03
OTHER FLUIDS
PUMPS

FLUIDS HANDLED

- Antifreeze and antifreeze solutions
- Windshield wash solutions
- Detergents
- AdBlue®/DEF
- Lubricants
- Waste oil
- Diesel

MARKETS SERVED

- Service shops
- Car and truck dealers
- In plant
- Agriculture
- Lube trucks
- Mining and construction
- Railroad and mass transit

MODELS						
PART No.	PUMP BODY	DIAPHRAGMS	BALLS	SEATS	OTHER WETTED MATERIAL	APPLICATIONS
551 164	Polypropylene	Hytrel®	Hytrel®	Stainless steel	Viton®	Antifreeze and Windshield wash solutions
551 164A	Polypropylene	Hytrel®	Hytrel®	Stainless steel	Viton®	BSP threads, special model for DEF
551 010	Aluminum	Hytrel®	Hytrel®	Stainless steel	Viton®	Antifreeze and Windshield wash solutions
551 030	Aluminum	Buna-N	Buna-N	Stainless steel	Buna-N	Antifreeze solutions, lubricants, diesel, waste oil evacuation and transfer

Tested at room temperature, with water and flooded pump with 31.5" (800 mm) height of water above the pump inlet.

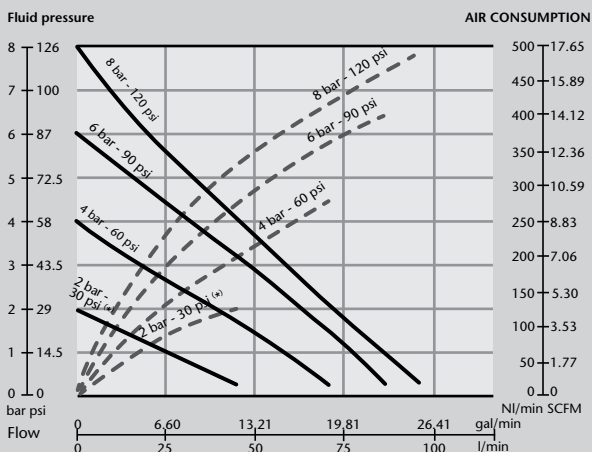

(*) 2 bar test with a pump fitted with PTFE (Teflon®) diaphragms. — Outlet pressure
- - - - - Air consumption

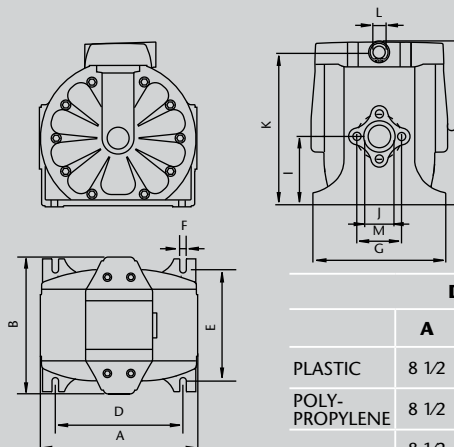

DIMENSIONS Inches

	A	B	C	D	E	F*
PLASTIC	8 1/2	8 37/64	9 1/16	6 57/64	6 1/16	5/16
POLY- PROPYLENE	8 1/2	6 19/64	8 15/16	6 57/64	6 1/16	23/64
	8 1/2	6 19/64	8 15/16	6 57/64	6 1/16	23/64
POLY- PROPYLENE	7 1/4	3 23/32	1 (F)	8 21/64	3/8 (F)	2 7/16
	METAL	7 1/4	3 23/32	1" (F)	8 17/64	3/8" (F)

* Diameter of the holes for fasteners in each of the four pump feet.
** Flange connection: 2 bolts - M 5 (1 39/64" between centers).

Product specifications are subject to change without prior notice

554 030

DF250 METAL DIAPHRAGM PUMPS. 66 GAL/MIN

Very reliable metal diaphragm pumps for large volume transferring (66 gal/min max.), dispensing and evacuating of a variety of fluids.

These pumps have an Aluminum air motor. Typical applications for these pumps are transferring and dispensing of antifreeze solutions, lubricants and diesel, and waste oil evacuation.

They can be used as stand-alone pumps for transfer applications or as systems pumps in distribution systems that include hose reels.

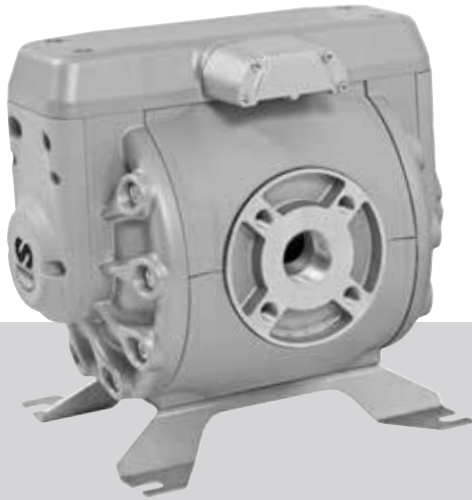

FLUIDS HANDLED

- Antifreeze and antifreeze solutions
- Lubricants
- Waste oil
- Diesel

MARKETS SERVED

- Service shops
- Car and truck dealers
- In plant
- Agriculture
- Lube trucks
- Mining and construction
- Railroad and mass transit

03
OTHER FLUIDS
PUMPS

MODELS						
PART No.	PUMP BODY	DIAPHRAGMS	BALLS	SEATS	OTHER WETTED MATERIAL	APPLICATIONS
554 010	Aluminum	Hytrel®	Hytrel®	Stainless steel	Viton®	Antifreeze solutions, lubricants
554 030	Aluminum	Buna-N	Buna-N	Stainless steel	Buna-N	Antifreeze solutions, lubricants, diesel, waste oil evacuation and transfer

Tested at room temperature, with water and flooded pump with 31.5" (800 mm) height of water above the pump inlet.

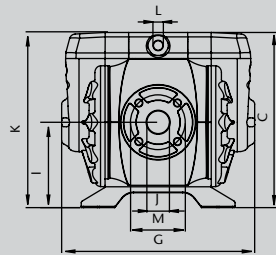
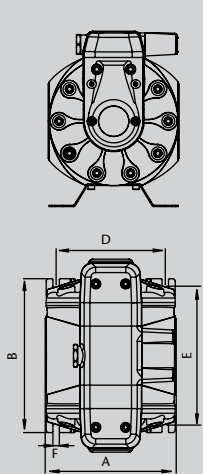

DIMENSIONS Inches					
A	B	C	D	E	F*
10 25/64	12 13/64	13 57/64	8 21/32	11 1/32	33/64
G	I	J	K	L	M
15 23/64	64 9/64	11/2 (F)	12 7/8	1/2 (F)	4 21/64**

* Diameter of the holes for fasteners in each of the four pump feet.
 ** DIN PN-10 flange connection: 4 bolts - M 16 (4 1/6" between centers).
 ** ANSI B16.5 150 lb flange connection: 4 bolts - UNC 1/2" - 13 (3 7/8" between centers).

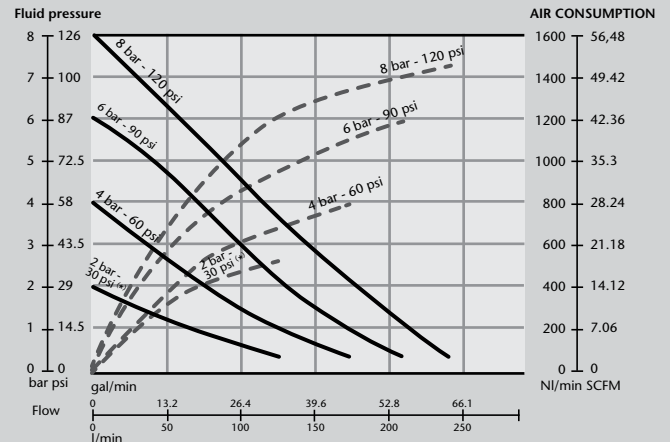

(*) 2 bar test with a TPE (Hytrel®) diaphragm pump.

— Outlet pressure
 - - - - - Air consumption

DP200 POLYPROPYLENE OR METAL DIAPHRAGM PUMPS. 53 GAL/MIN

555 164 / 555 030

Very reliable diaphragm pumps for large volume transfer (53 gal/min max.), dosing, and dispensing a variety of fluids.

Typical applications for **polypropylene pumps** are transferring and dispensing of Windshield wash and antifreeze solutions and AdBlue®/DEF.

Metal pumps have an Aluminum air motor. Typical applications for these pumps are transferring and dispensing of antifreeze solutions, lubricants, diesel, and waste oil evacuation.

They can be used as stand-alone pumps for transfer applications or as systems pumps in distribution systems that include hose reels.

Pump inlet and outlet ports can be mounted in different positions for increased installation versatility.

FLUIDS HANDLED

- Antifreeze and antifreeze solutions
- AdBlue® / DEF
- Lubricants
- Waste oil
- Diesel
- Windshield wash solutions

MARKETS SERVED

- Service shops
- Car and truck dealers
- In plant
- Agriculture
- Lube trucks
- Mining and construction
- Railroad and mass transit

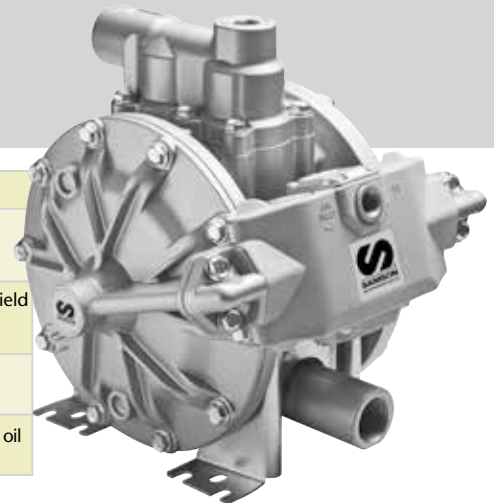

03
OTHER FLUIDS
PUMPS

MODELS						
PART No.	PUMP BODY	DIAPHRAGMS	BALLS	SEATS	OTHER WETTED MATERIALS	APPLICATIONS
555 164	Polypropylene	HytreI®	PTFE	Polypropylene	Viton®, Stainless steel	Antifreeze and Windshield wash solutions, Ad Blue®/DEF
555 010	Aluminum	HytreI®	Acetal	HytreI®	Viton®, Stainless steel	Antifreeze solutions, lubricants
555 030	Aluminum	Buna-N	Acetal	Buna-N	Stainless steel	Lubricants, diesel, waste oil evacuation and transfer

Polypropylene pump 555 164 has flange connection only. Order kits 1940, one for pump inlet and one for pump outlet, separately.

Tested at room temperature, with water and flooded pump with 31.5" (800 mm) height of water above the pump inlet.

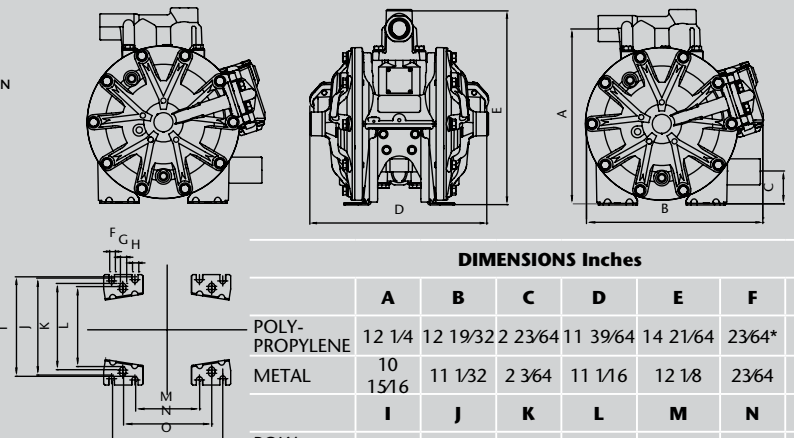
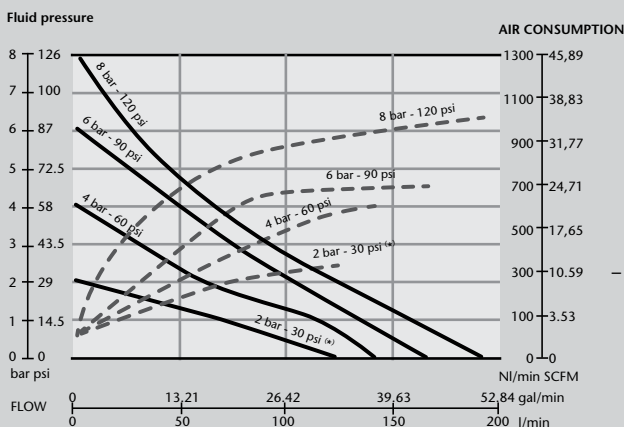

DIMENSIONS Inches							
	A	B	C	D	E	F	G/H
POLY-PROPYLENE	12 1/4	12 19/32	2 23/64	11 39/64	14 21/64	2364*	
METAL	10 15/16	11 1/32	2 3/64	11 1/16	12 1/8	2364	2564
	I	J	K	L	M	N	O
POLY-PROPYLENE				6 1/16		6 57/64	
METAL	6 7/32	6 1/16	5 25/64	13/64	4 1/64	5 33/64	6 57/64

(*) 2 bar test with a PTFE (Teflon®) diaphragm pump.

— Outlet pressure
- - - - Air consumption

* Diameter of the holes for fasteners in each of the four pump feet.

DIAPHRAGM PUMP ACCESSORIES

DIAPHRAGM PUMP WALL BRACKETS



- 360 100** Wall bracket for DF30 and DF50 pumps.
- 360 101** Wall bracket for DF100 pumps.
- 360 142** Wall bracket for DP200 pumps.
- 360 144** Wall bracket for DF250 pumps.
- 360 131** Wall bracket for pumps Part No. 2835 and 2836

DIAPHRAGM PUMP SUCTION KITS FOR LUBRICANTS



For use with 55 gallon drums, 44 - 48" tanks or 250 gallon IBCs.

367 005. Suction kit for DF100 and DF50 pumps.

Includes metal suction tube with foot valve and bung adaptor. 47" suction tube and 78" suction hose. Includes a 3/4" x 1" MM and a 3/4" x 1/2" MM connection adaptor for connecting to a DF100 or a DF50 pump.

367 007 Suction kit for DF250 and DP200 pumps.

Includes 47" x 1" metal suction tube with foot valve and bung adaptor and elbow for connecting to a 78" x 1" M suction hose.

DIAPHRAGM PUMP SUCTION KITS FOR WATER BASED FLUIDS

For use with 55 gal drums or 250 gallon IBCs. Not for use with lubricants.



367 020 Suction kit for DF30 and DF50 pumps.

Includes 60" x 1/2" EPDM suction hose, foot valve with filter and two 1/2" NPT (M) hose barb connector with clips.

367 021 Suction kit for DF100 and DP200 pumps.

Includes 60" x 1" EPDM suction hose, foot valve with filter and two 1" NPT (M) hose barb connector with clips.

DIAPHRAGM PUMP SUCTION KITS FOR WASTE FLUIDS

Kits include either a 3/4" Cam-lock and ball valve or a 3/4" hydraulic connector, 60" transparent, spring reinforced suction hose and a Y-strainer.



MODELS WITH HYDRAULIC CONNECTOR
367 022 Suction kit for DF50 pumps.

Includes 3/4" hydraulic connector, 60" x 3/4" suction hose, Y-strainer and connecting adaptors for mounting the assembly to a DF50 metal pump.

367 023 Suction kit for DF100 and DP200 pumps. Includes 3/4" hydraulic connector, 60" x 1" suction hose, Y-strainer and connecting adaptors for mounting the assembly to a DF100 or a DP200 metal pump.



MODELS WITH CAM-LOCK CONNECTOR
367 024 Suction kit for DF100 and DP200 pumps.

Includes 3/4" Cam-lock and ball valve, 60" x 1" suction hose, Y-strainer and connecting adaptors for mounting the assembly to a DF100 or a DP200 metal pump.

367 025 Suction kit for DF250. Includes 3/4" Cam-lock and ball valve, 60" x 1" suction hose, Y-strainer and adaptors for mounting the assembly to a DF250 pump.

PUMP INSTALLATION EXAMPLES

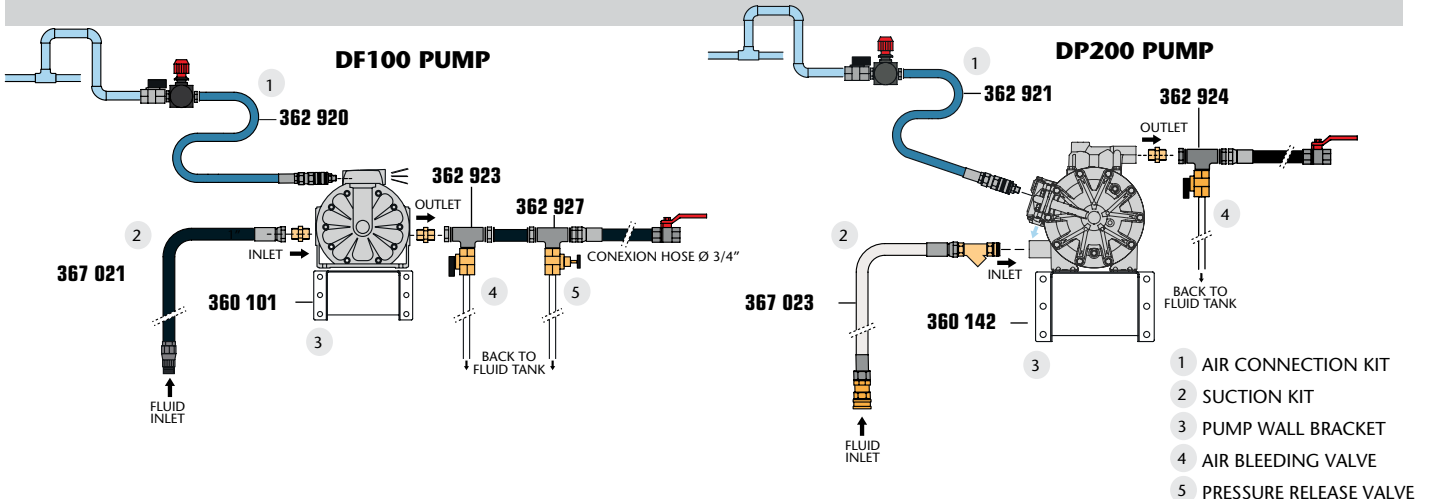

DIAPHRAGM PUMP ACCESSORIES



DIAPHRAGM PUMP AIR CONNECTION KITS

Air connection kits include all components required for connecting a diaphragm pump to the air supply and an air pressure regulator for controlling pump speed.

362 920



362 920	362 921	362 922
Air connection kit for DF30, DF50 and DF100 pumps	Air connection kit for DP200 pumps	Air connection kit for DF250 pumps
INCLUDES		
Part No. 933M06, 3/8" NPT (M) air nipple	Part No. 936M06, 3/8" NPT (M) air nipple	Part No. 936M08, 1/2" NPT (M) air nipple
Part No. 930F04, 1/4" NPT (F) air coupler	Part No. 935F06, 3/8" NPT (F) air coupler	Part No. 935F06, 3/8" NPT (F) air coupler
Part No. 802, 5' x 1/4" air hose	Part No. 815, 5' x 3/8" air hose	Part No. 815, 5' x 3/8" air hose
Part No. 970, 1/4" air pressure regulator	Part No. 973, 3/8" air pressure regulator	Part No. 973, 3/8" air pressure regulator
Part No. 2051, 1/4" NPT (MM) connection adaptor	Part No. 2035, 3/8" x 1/2" NPT (MM) connection adaptor	Part No. 2035, 3/8" x 1/2" NPT (MM) connection adaptor
Part No. 2013, 1/4" NPT (FF) air valve	Part No. 2088, 1/2" NPT (FF) air valve	Part No. 2088, 1/2" NPT (FF) air valve

PRESSURE RELIEF VALVES

When connected to the pump outlet, it helps to prevent damage in the pump and in the distribution line caused by overpressure due to thermal expansion of the fluid. Pressure relief valves can be adjusted from 0 to 145 psi pressure.



Part No. 170 008

1/2" Pressure relief valve. For DF50 diaphragm pumps.

Part No. 107 016

1" Pressure relief valve. For DF100, DP200, 2835 and 2836 diaphragm pumps.

Part No. 170 024

1-1/2" Pressure relief valve. For DF250 and 2838 diaphragm pumps.

Part No. 170 032

2" Pressure relief valve. For 2840 diaphragm pumps.

DIRECTFLO® PUMP SILENCER



558 338

Part No. 558 405

Air exhaust connection kit. When placed at the air exhaust port instead of the standard air muffler, allows connecting a hose for air exhaust remote evacuation. Required when the pump is mounted submerged or when the air exhaust has to be vented outside the pump room. Connection thread: 3/8".

Part No. 558 338

Pump silencer. When placed at the pump air exhaust port instead of the standard air muffler, it reduces the pump noise level below 70 dB. Includes air exhaust connection kit 558 405.

DIRECTFLO® UNIVERSAL BRACKET



360 137

Part No. 360 137

Universal bracket with carrying handle. Fits a DF30 or a DF50 diaphragm pump on top of a drum or an IBC.

FLANGE CONNECTION KIT

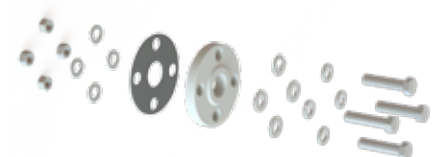

Part No. 1940

Flange connection kit. For use with DP200 polypropylene pump P.N. 555 164. Includes one ANSI Standard 1" flange with seal and fastening elements. Use two kits for pump, one for the inlet port and the second one for the outlet port.

AIR BLEEDING VALVES

When connected to the pump outlet, it helps to eliminate the air trapped in the pump and in the suction line aiding pump prime.



362 922

362 922, 1/2" Air bleeding valve. For DF30 and DF50 diaphragm pumps.

362 923, 3/4" Air bleeding valve. For DF100 diaphragm pumps.

362 924, 1" Air bleeding valve. For DF250 and DP200 diaphragm pumps.

03
OTHER FLUIDS
PUMPS

2836



40 GALLONS PER MINUTE ALUMINUM UL LISTED PUMP

Part No. 2836

40 gallons per minute maximum free flow capacity. Aluminum chambers and Buna-N diaphragms and check valves. 1" NPT (F) inlet and outlet ports. UL listed pump, suitable for lubricants, diesel and waste oil transfer and evacuation.

2835



46 GALLONS PER MINUTE ALUMINUM PUMP

Part No. 2835

46 gallons per minute maximum free flow capacity. Aluminum chambers and Buna-N diaphragms and check valves. 1" NPT (F) inlet and outlet ports. Suitable for antifreeze, lubricants, diesel and waste oil transfer and evacuation.

2838



107 GALLONS PER MINUTE ALUMINUM PUMP

Part No. 2838

107 gallons per minute maximum free flow capacity. Aluminum chambers and Buna-N diaphragms and check valves. 1-1/2" NPT(F) inlet and outlet ports. Suitable for antifreeze, lubricants, diesel and waste oil transfer and evacuation.

2840



164 GALLONS PER MINUTE ALUMINUM PUMP

Part No. 2840

164 gallons per minute maximum free flow capacity. Aluminum chambers and Buna-N diaphragms and check valves. 2" NPT (F) inlet and outlet ports. Suitable for antifreeze, lubricants, diesel and waste oil transfer and evacuation.

FOUR-WAY EVACUATION VALVE

FILL TANK POSITION

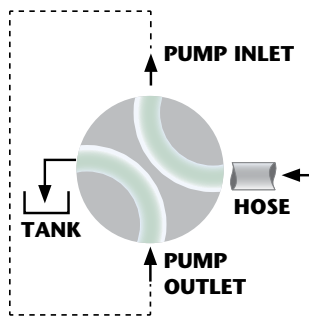

EMPTY TANK POSITION

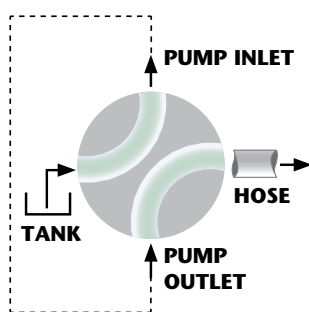

361 300

Part No. 361 300

Four-way evacuation valve

It simplifies plumbing and allows the use of one pump to pull and push waste fluids on / off their storage tank with the swing of a handle.

The valve is manufactured in anodized aluminum and acetal and it has 1" NPT (F) connection threads.

- Lube trucks
- Construction and mining
- Manufacturing facilities.